

**ENTRY**

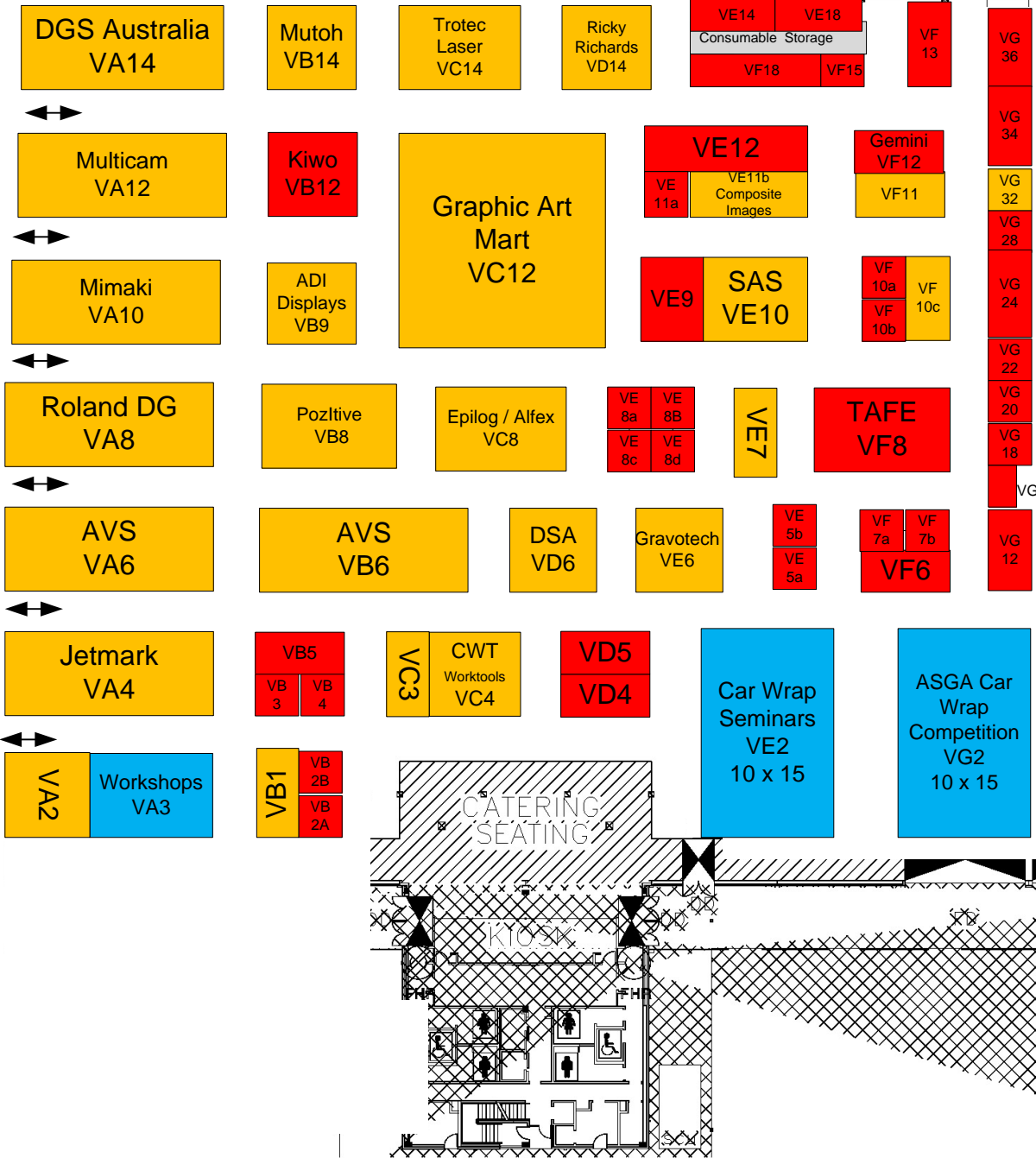
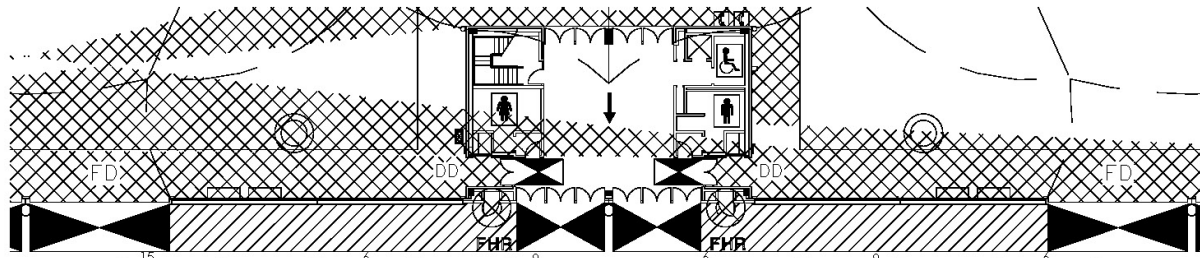

- VB1 – VI Magazine
- VB2A – LED Works
- VB2B – The Curator Company
- VB3 – Best Value Trading
- VB4 – Ecolease
- VB5 – Laser and Sign Technology
- VC3 – Sign To Badge Solutions
- VD4 – Signmaker's Choice
- VD5 – LED Wizard
- VE5a – Blue Online
- VE5b – iMAAGE
- VE7 – Hangzhou Bannermate Exhibition System Co.,Ltd
- VE8a – Jiangsu Naisi Digital Technology Inc.,Ltd.
- VE8b – Shenzhen Mountain A-Li
- VE8c – Shenzhen LingBenYang Industry
- VE8d - Haining Xiangyu
- VE9 – Elizabeth Machines
- VE11a – KiM
- VE12 – Stahls Pacific
- VE14 – AAA Plaques
- VE18 – Chief media
- VF6 – Adzon
- VF7a – M-Power Software
- VF7b – SGIAA
- VF10a – Eurotech
- VF10b – SAled Australia
- VF10c – Ullrich Aluminium
- VF11 – New Concept Sign & Display
- VF13 – Wi Path Communications
- VF15 – Engravers Register
- VF18 – Sign Sheet Distributors
- VG12 – Image Magazine
- VG16 – Eyelets
- VG18 – Impression Technology
- VG20 – ASGA
- VG22 - Haining Jinmao
- VG24 – Massage
- VG28 – Top Craftsman Dongguan
- VG32 – Jiangmen Eastern Signs Co.,Ltd
- VG34 – ST3D
- VG36 – Nova Sublimation
- VA2 – Techie On Wheels
- VA2 – Insurance House

**VISUAL IMPACT SYDNEY 2015 (Co Located with Printex 15)  
HALL 3, SYDNEY SHOWGROUND, SYDNEY OLYMPIC PARK  
13 - 15 MAY 2015**

\* Flooplan subject to change \* Correct as at 8 May 2015

Yellow – floor space  
Red – shell scheme